

# Natural Wonders Waterfalls Water Inlet Spacing Chart

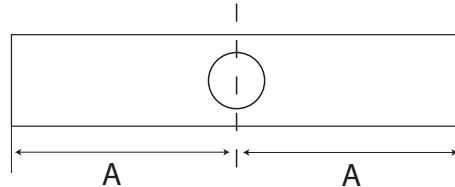

## 12" - 48" Waterfalls - Back & Bottom Port (Includes Standard Waterfalls, StreamFalls, RainFalls, & Arch Waterfalls)



For 12" falls  $A = 6-11/32"$   
For 18" falls  $A = 9-9/32"$   
For 24" falls  $A = 12-3/16"$   
For 36" falls  $A = 18-1/8"$   
For 48" falls  $A = 23-15/16"$

## 60" & 72" Waterfalls - Back & Bottom Port (Only Standard Waterfalls Are Available In Sizes Over 48")

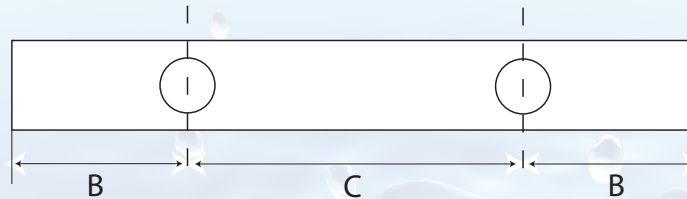

For 60" falls  $B = 18-1/4"$  &  $C = 23-11/32"$   
For 72" falls  $B = 19-27/32"$  &  $C = 31-15/16"$

## 84" & 96" Waterfalls - Back & Bottom Port (Only Standard Waterfalls Are Available In Sizes Over 48")

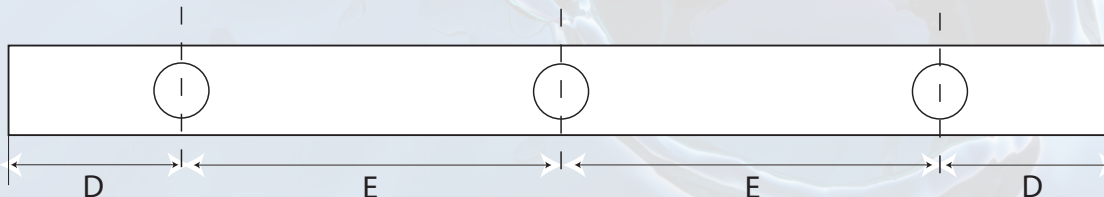

For 84" falls  $D = 18-1/32"$  &  $E = 23-5/8"$   
For 96" falls  $D = 19-31/32"$  &  $E = 27-9/16"$

**Custom Molded Products, Inc.**

09/10zv

Toll Free: 800.733.9060 or visit us online at [www.c-m-p.com](http://www.c-m-p.com)

**Contact us for details about our complete line of pool, spa & whirlpool bath components!!**

